

客户信息/ Customer info.	ECN 编号	图号/图号	数量	版本	签名	日期
版本/REV.	ECN No.	Drawing mark	Places	REV.	Sign	Date
--	--	--	--	E1	Luo Jinbo	20200420

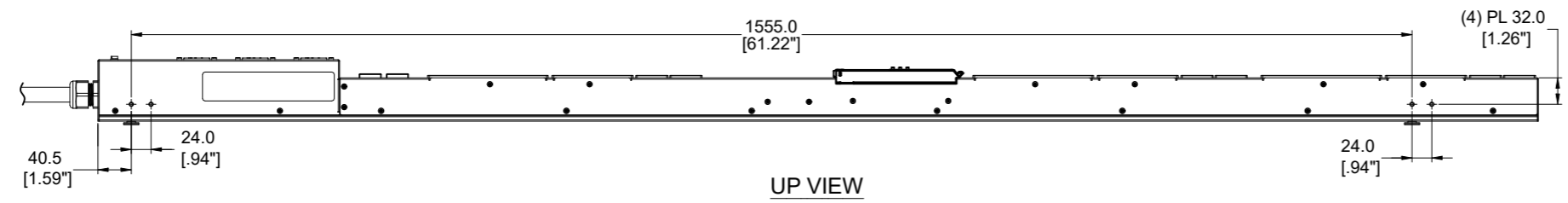

UP VIEW

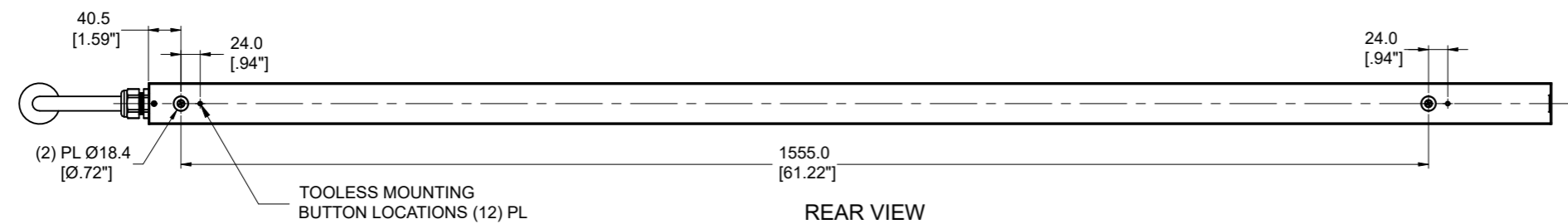

REAR VIEW

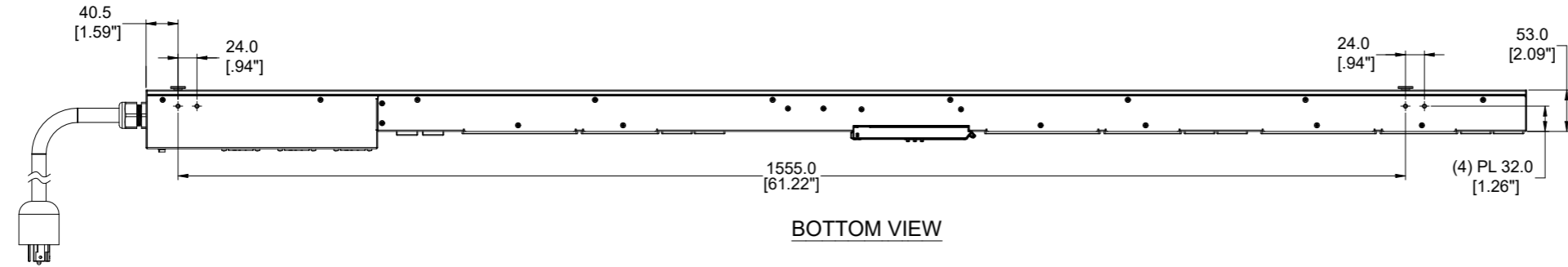

BOTTOM VIEW

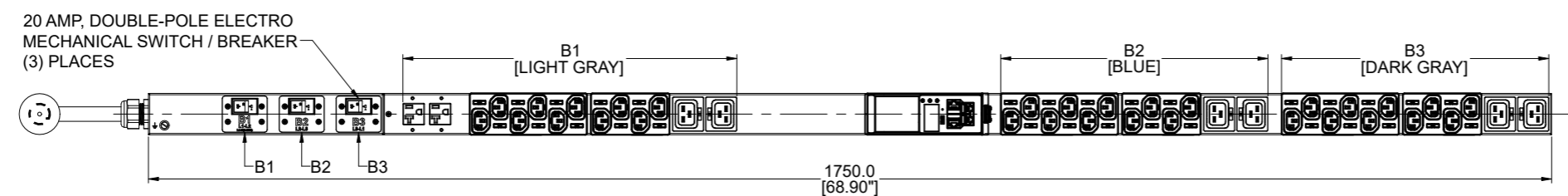

FRONT VIEW

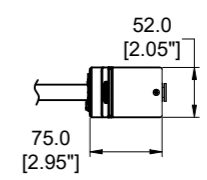

RIGHT VIEW

**PLUG/RECEPTACLE BLOCK**

- PLUG  
NEMA L21-30P, 4P 5W  
30A, 120/208V MAX RATED INPUT  
24A DERATED
- RECEPTACLES  
NEMA 5 - 20R  
20A, 125V MAX RATED OUTPUT
- RECEPTACLES  
IEC 60320/C19  
16A, 250V MAX RATED OUTPUT
- RECEPTACLES  
IEC 60320/C13  
10A, 250V MAX RATED OUTPUT

**SPECIFICATION:**

1. STANDARD:
- UNIT TYPE: MONITORED INPUT
  - ORIENTATION: VERTICAL, 0U FULL
  - OUTLET QTY & TYPE: (30) C13, (6) C19, (2) 5-20R
  - INPUT VOLTAGE: 100-120/200-240VAC
  - INPUT CURRENT: 30A (24A DERATED)
  - BREAKER QTY & TYPE: (3) 20AMP, DOUBLE-POLE
  - INPUT PHASE: THREE-PHASE, WYE
  - RATED POWER: 8.6 kVA
  - INPUT PLUG: NEMA L21-30P
  - INPUT POWER CORD: 3m[10'], TOP FEED
  - REGULATORY STANDARD: RoHS COMPLIANT

<b>CISGLOBAL</b>				项目 Project	EN2.0	阶段标记	
泛亚电子工业无锡有限公司				图号 PN	TA-EN1806A	S	
设计/Design	Jingbo Luo	日期/Date	2020.05.20	名称 Title	PDU	重量/Weight	N/A
审核/Check	Aric Wang	日期/Date	2020.05.20	材料 Material	Assembly	比例/Scale	1:3
工艺检查/Review	Talon LV	日期/Date	2020.05.20			幅面/Size	A2
批准/Approve	Hanson Xu	日期/Date	2020.05.20			共1页	第1页