

客户信息/Customer info.	ECN 编号	图号/图号	数量	版本	签名	日期
版本/REV.	ECN No.	Drawing mark	Places	REV.	Sign	Date
--	--	--	--	E1	Luo Jinbo	20200420

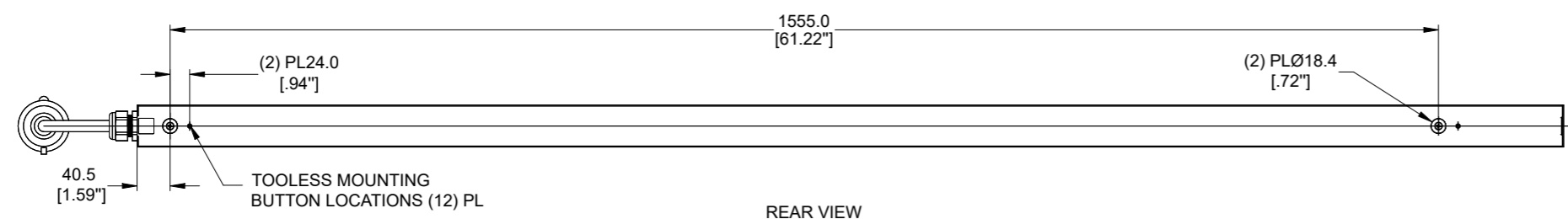

BOTTOM VIEW



REAR VIEW

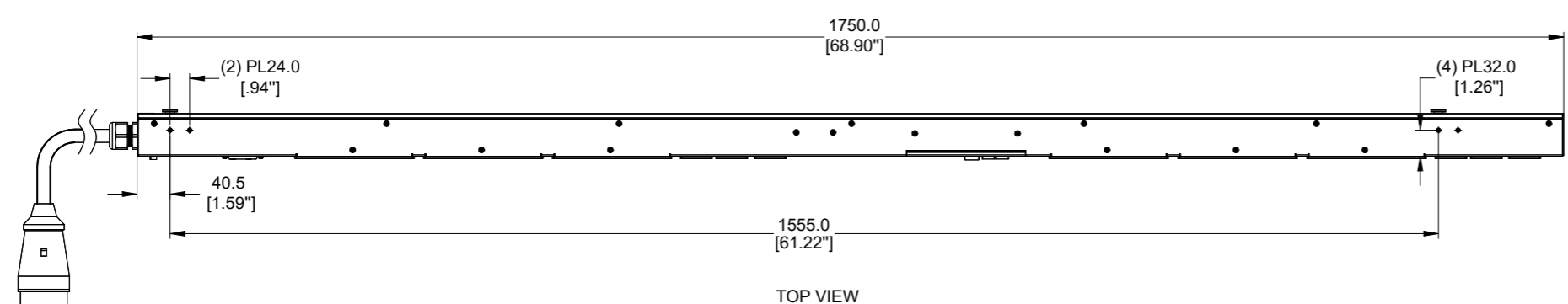

TOP VIEW

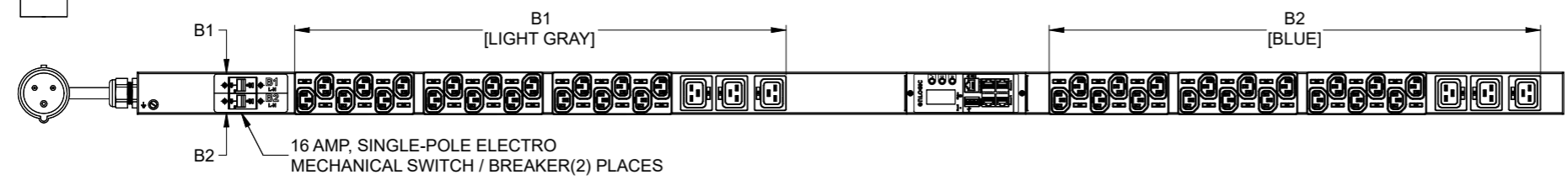

FRONT VIEW

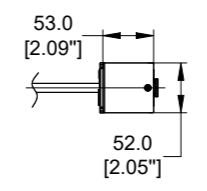

RIGHT VIEW

SPECIFICATION:

1. STANDARD:
- | | |
|----------------------|------------------------|
| UNIT TYPE: | MONITORED INPUT |
| ORIENTATION: | VERTICAL, 0U FULL |
| OUTLET QTY&TYPE: | (36) C13, (6) C19 |
| INPUT VOLTAGE: | 100-240VAC |
| INPUT CURRENT: | 32A |
| BREAKER QTY&TYPE: | (2) 16AMP, SINGLE-POLE |
| INPUT PHASE: | SINGLE-PHASE |
| RATED POWER: | 7.4kVA |
| INPUT PLUG: | IEC 60309 2P+E 6H 32A |
| INPUT POWER CORD: | 3m[10], TOP FEED |
| REGULATORY STANDARD: | RoHS COMPLIANT |

PLUG/RECEPTACLE BLOCK

	PLUG IEC 60309, 2P 3W, 6H IP44 (SPASHPROOF) 32A, 200-250V MAX RATED INPUT
	RECEPTACLES IEC 60320/C19 16A, 250V MAX RATED OUTPUT
	RECEPTACLES IEC 60320/C13 10A, 250V MAX RATED OUTPUT

CISGLOBAL				项目	EN2.0	阶段标记	
				Project	TA-ES1337A	S	
泛亚电子工业无锡有限公司				图号	TA-ES1337A		
设计/Design	Jingbo Luo	日期/Date	2020.05.20	名称	PDU	重量/Weight	N/A
审核/Check	Aric Wang	日期/Date	2020.05.20	Title		比例/Scale	1:3
工艺检查/Review	Talon LV	日期/Date	2020.05.20	材料	Assembly	规格/Size	A2
批准/Approve	Hanson Xu	日期/Date	2020.05.20	Material		共1页	第1页